

# ELLO SYSTEM

INSTALLATION INSTRUCTIONS | NOVEMBER 2022

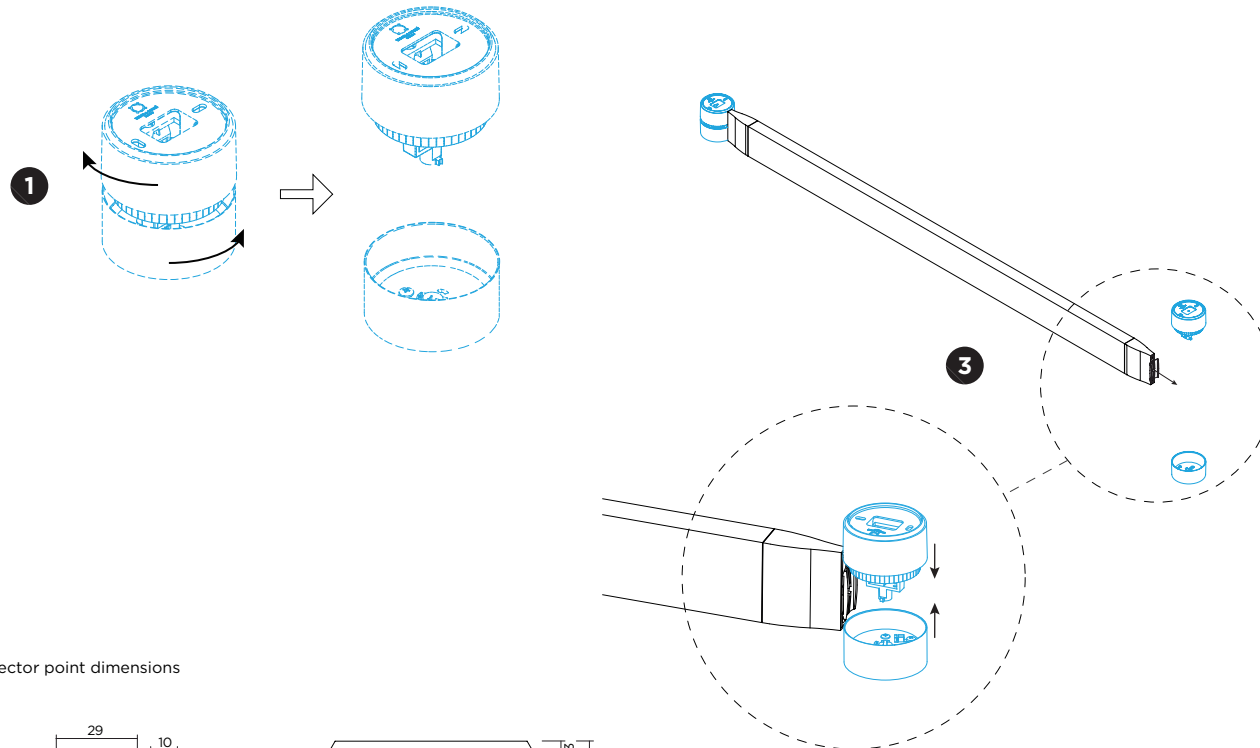

connector point dimensions

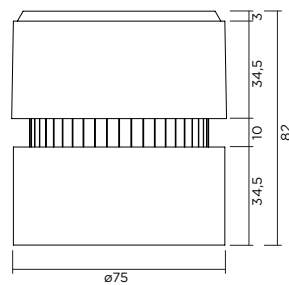
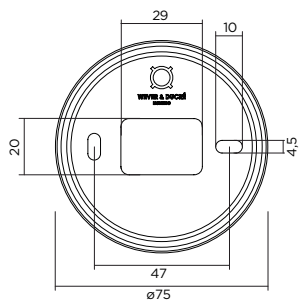

## CEILING SURFACE - DIMENSIONS

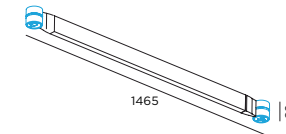

## MOUNTING INSTRUCTION

- 1 Open the connector point by turning the two halves a quarter and mount the top part to the ceiling with screws (screws are not included).

## POWER CONNECTION

- 2 PARALLEL CONNECTION

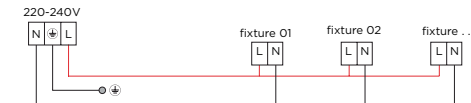

Connect the earthing cable to the top part of the connector point.

- 3 Place the flaps of the Ello between the two parts of the connector point and connect to power. Fix the bottom part of the connector point back to the top part and close it by turning a quarter.

Note:

- per connector point there can only be 4 Ello phase-cut dimmable fixtures and 2 Ello DALI fixtures, for this extra wire connectors are added
- leave the connectors on the unused wires to keep electrical isolation
- per Ello power connection you can connect maximum 10 fixtures

# ELLO SYSTEM

INSTALLATION INSTRUCTIONS | NOVEMBER 2022

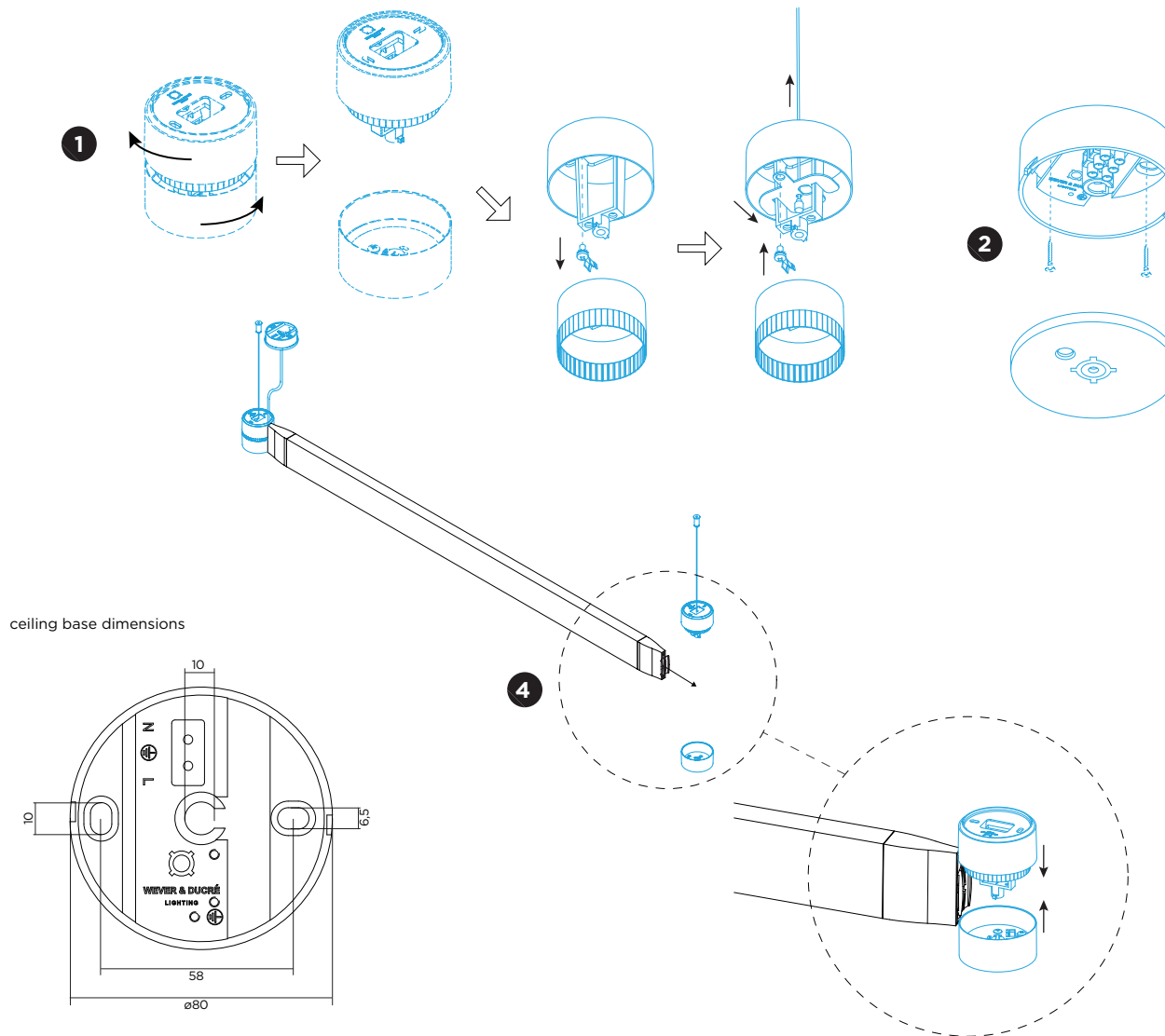

## CEILING SUSPENDED - DIMENSIONS

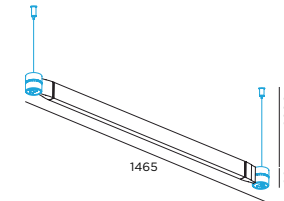

## MOUNTING INSTRUCTION

- 1 Open the connector point by turning the two halves a quarter and attach the top part to the suspension cable.
- 2 Open the ceiling base and mount it to the ceiling with screws.  
After connecting the cable, put on the top part again.

## 3 POWER CONNECTION PARALLEL CONNECTION

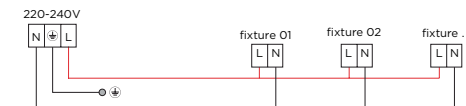

Connect the earthing cable to the top part of the connector point.  
put the wire through the strain relief which fixed on the suspension cables.

- 4 Place the flaps of the Ello between the two parts of the connector point and connect to power.  
Fix the bottom part of the connector point back to the top part and close it by turning a quarter.

Note:

- per connector point there can only be 4 Ello phase-cut dimmable fixtures and 2 Ello DALI fixtures, for this extra wire connectors are added
- leave the connectors on the unused wires to keep electrical isolation
- for suspended version:  
\* Ello can also be used as an uplight  
\* per Ello system you need at least 1 power feeder  
\* per Ello power connection you can connect maximum 10 fixtures  
\* Ello power feeder already includes 1 suspension cable

# ELLO SYSTEM

INSTALLATION INSTRUCTIONS | NOVEMBER 2022

## BE CREATIVE

SOME EXAMPLES:

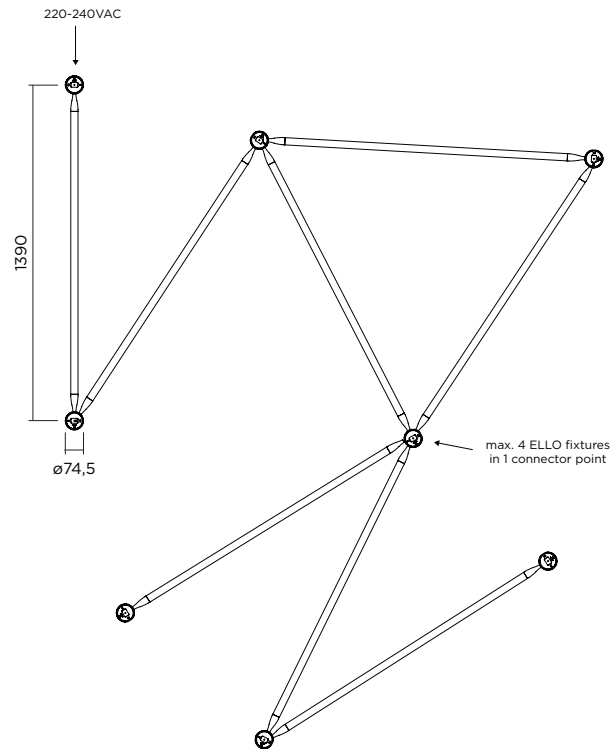

### WHAT YOU NEED

8x ELLO FIXTURE  
8x CONNECTOR POINT  
in case of suspensions version also:  
7x SUSPENSION CABLE  
1x POWER FEEDER

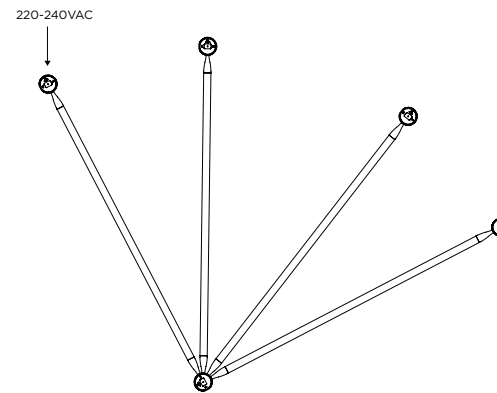

### WHAT YOU NEED

4x ELLO FIXTURE  
5x CONNECTOR POINT  
in case of suspensions version also:  
4x SUSPENSION CABLE  
1x POWER FEEDER

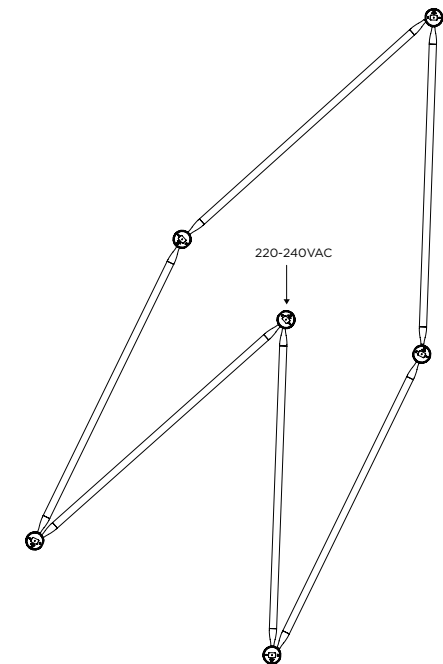

### WHAT YOU NEED

6x ELLO FIXTURE  
6x CONNECTOR POINT  
in case of suspensions version also:  
5x SUSPENSION CABLE  
1x POWER FEEDER



**WEVER & DUCRÉ**  
LIGHTING

**WEVER & DUCRÉ BV**

Spinnerijstraat 99/21, 8500 Kortrijk, Belgium  
weverducre.com

# ELLO SYSTEM

INSTALLATION INSTRUCTIONS | NOVEMBER 2022

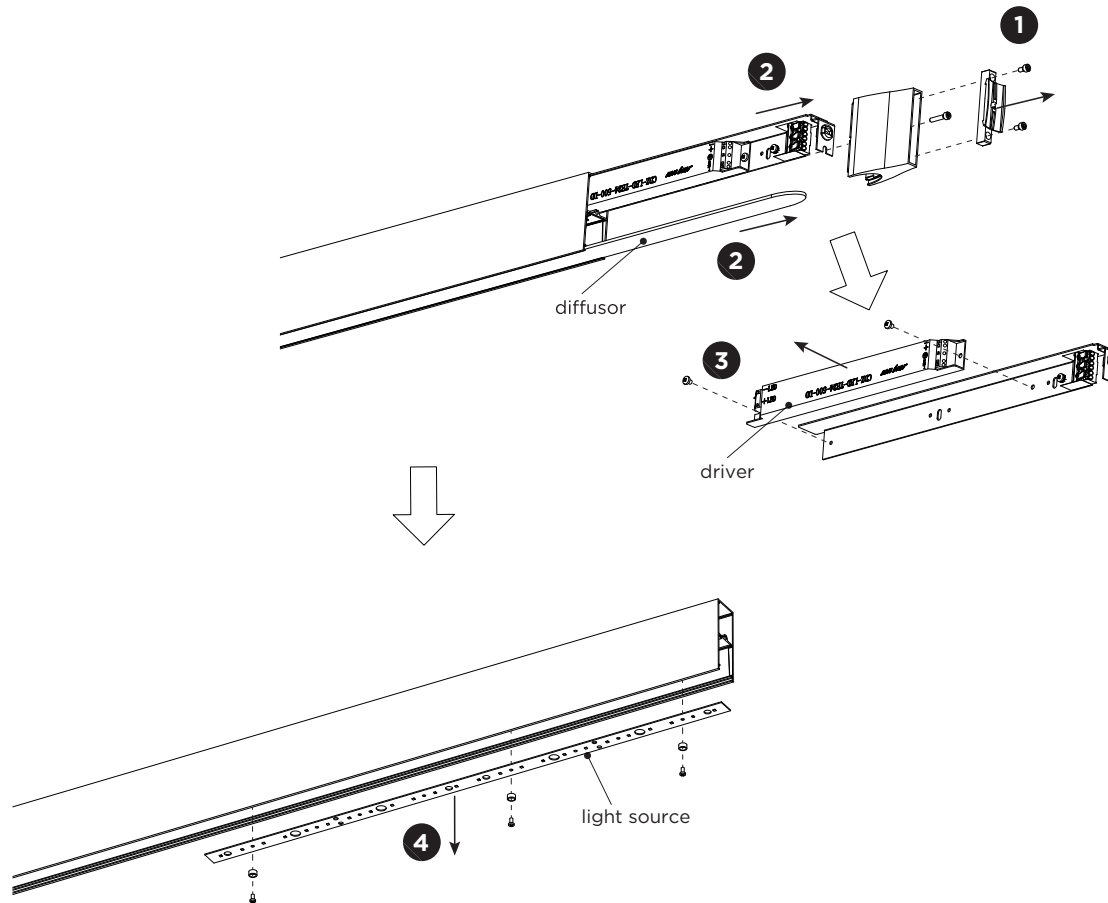

## DISMOUNTING AND RECYCLING INSTRUCTIONS

### Light source & driver

- 1 Unscrew the clips on both sides and remove the endcaps.
- 2 Pull out the bracket and the diffuser.
- 3 Unscrew, loosen the wires and remove the driver from the bracket.
- 4 Remove the light source by loosening the screws.

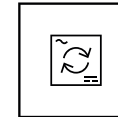

The driver can be replaced by the end user.

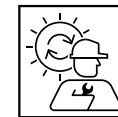

The light source is replaceable by an authorized professional.  
For advice contact your Wever & Ducre customer service contact point.



This luminaire contains a light source with the energy class F.