

STAKE

INSTALLATION INSTRUCTIONS | NOVEMBER 2022

mount on the floor

mount on the spike

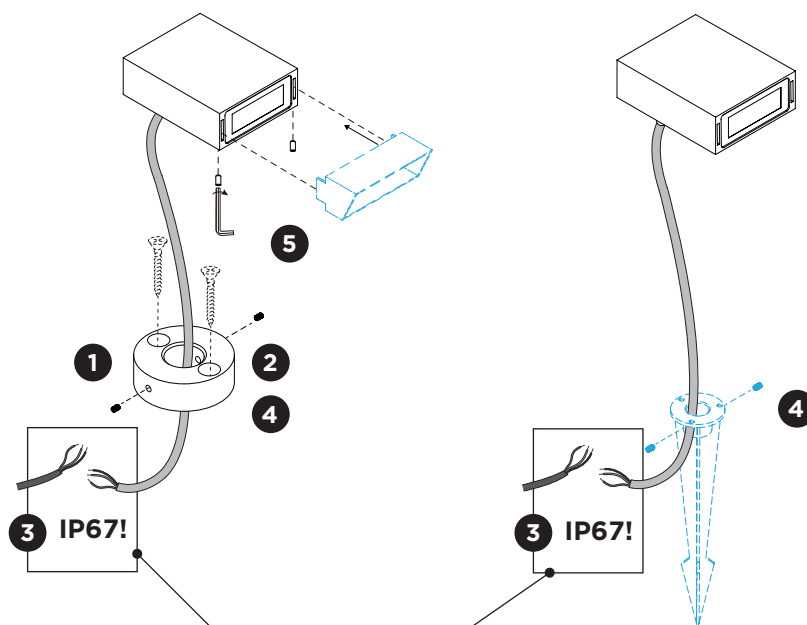

OPTIONAL
snoot dimensions
90019004

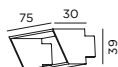

OPTIONAL
groundspike dimensions
90013106



Included:

waterproof connectors:



Optional:

IP68 connection box:

order ref. 73240707 = 2 WAYS 3x1,5 Ø8-10mm

DIMENSIONS

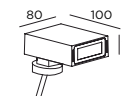

STAKE 1.0

MOUNTING INSTRUCTION

- 1** Remove the base plate from the luminaire by loosening the side screws.
- 2** Mount the base plate to the floor (screws are not included).
- 3 POWER CONNECTION**
Connect to 220-240V. Connect the wires with the waterproof connections.
- 4** Attach the fixture back to the base plate / ground spike with the side screws.
- 5** OPTIONAL
Mount the snoot on the Stake and lock it with the allen screws.

PB19-010-364-00_V3

STAKE

INSTALLATION INSTRUCTIONS | NOVEMBER 2022

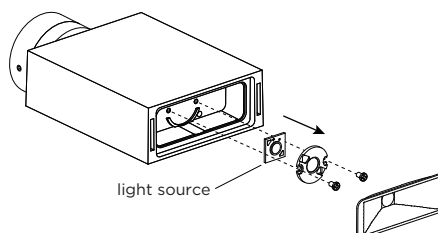
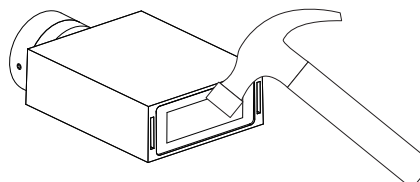
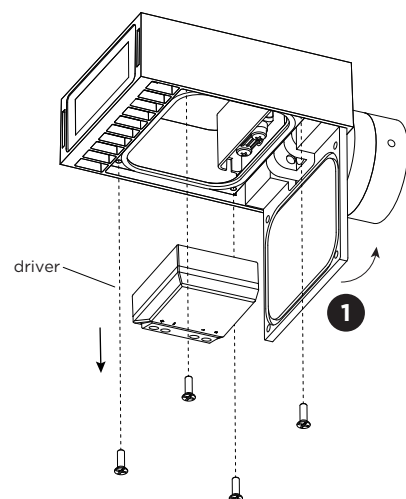

DISMOUNTING AND RECYCLING INSTRUCTIONS

Light source & driver

- 1 Loosen the screws and tilt the cover.
- 2 Remove the driver by loosening the cables.
- 3 Break the glass.
- 4 Take out the reflector and unscrew the light source.

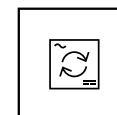

The driver can be replaced by the end user.

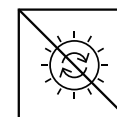

The light source is not replaceable.



This luminaire contains a light source with the energy class F.



WEVER & DUCRÉ
LIGHTING

WEVER & DUCRÉ BV

Spinnerijstraat 99/21, 8500 Kortrijk, Belgium
weverducre.com